

HITACHI

LIST NO. 0904

ELECTRIC TOOL PARTS LIST

■ ROTARY BAND SAW
Model CB 18FA

1995 · 10 · 5
(E2)

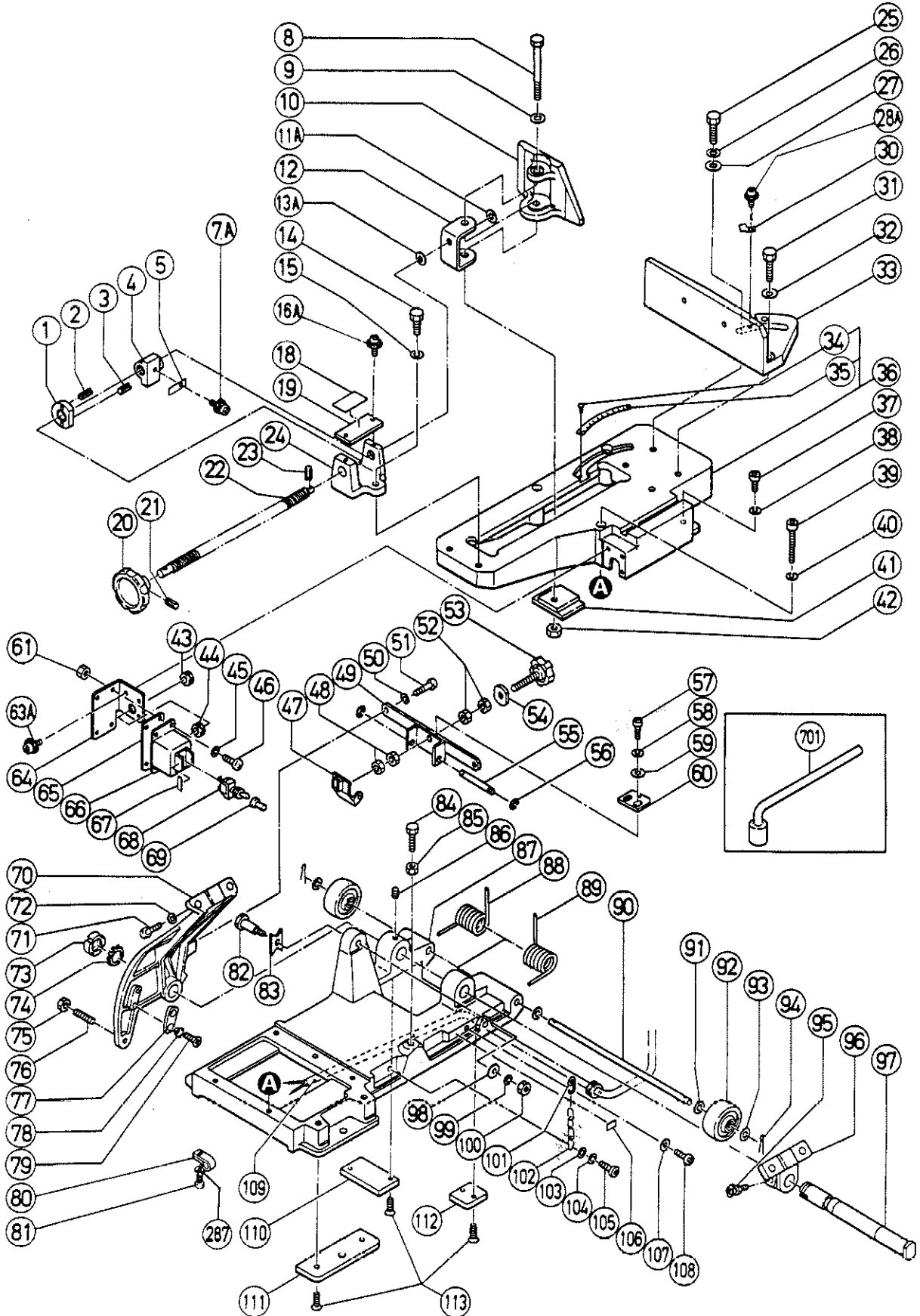

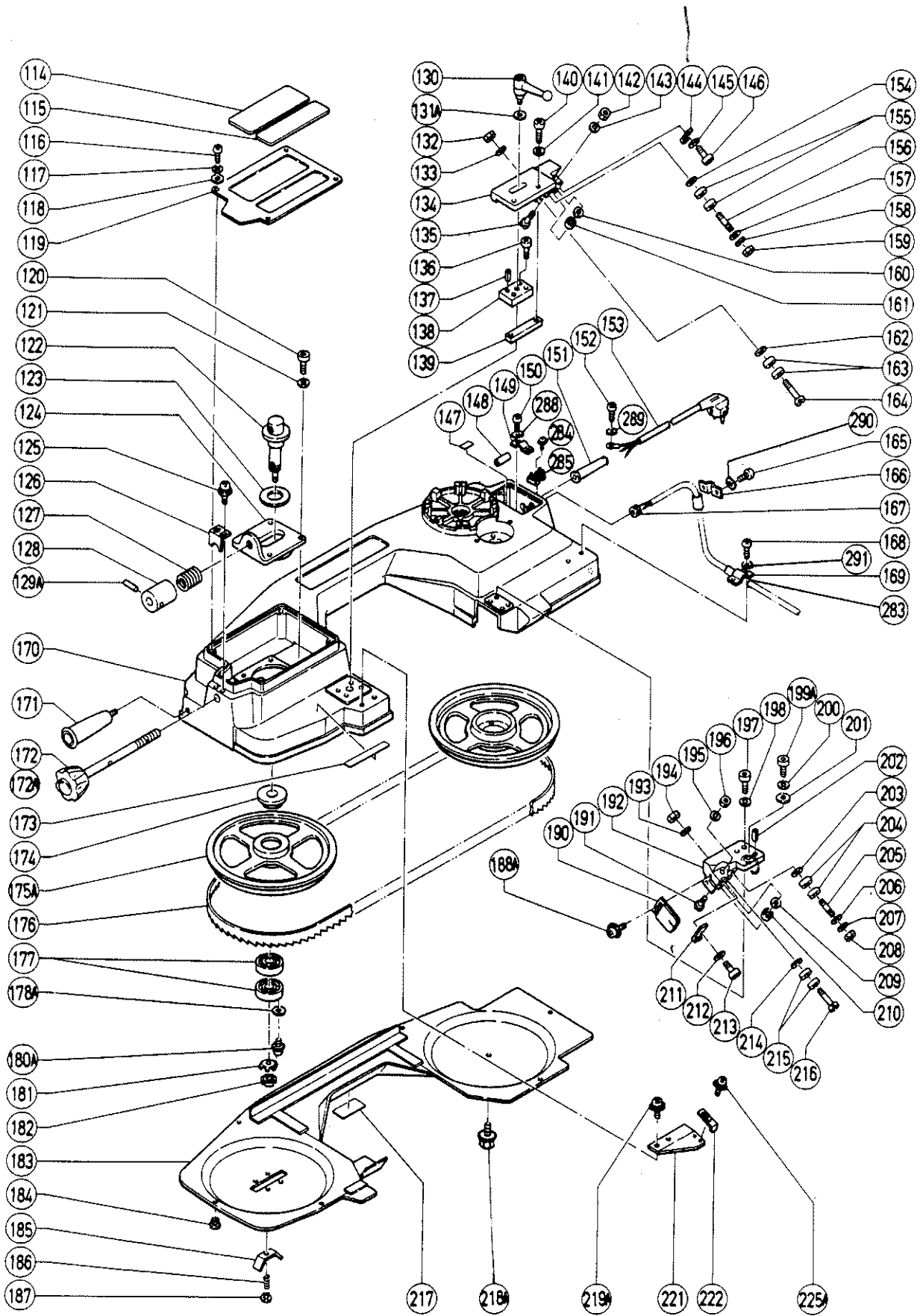

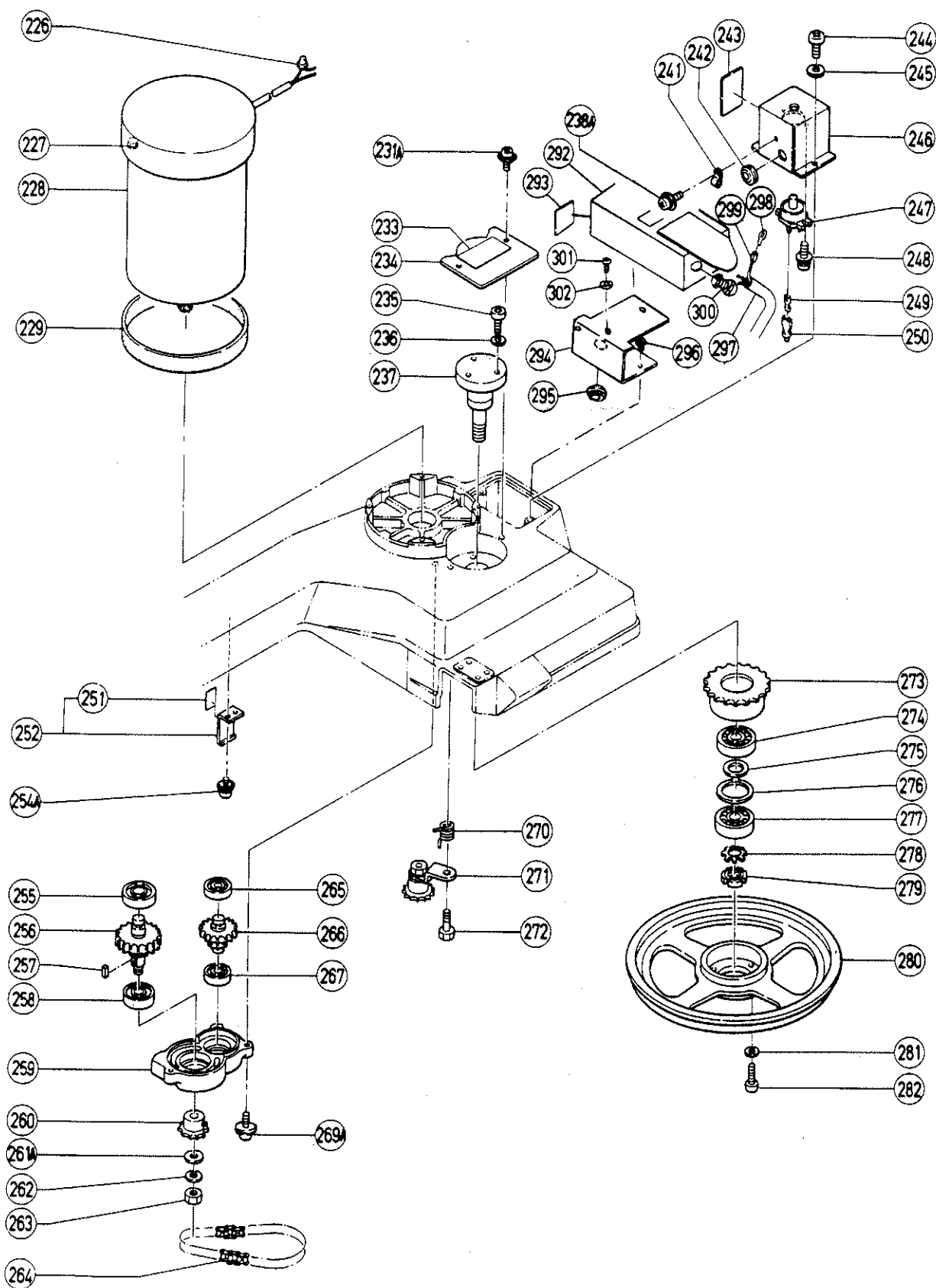

PARTS

CB 18FA

ITEM NO.	CODE NO.	DESCRIPTION	NO. USED	REMARKS
1	988-811	DISTANCE SLEEVE	1	
2	949-497	ROLL PIN D4X16 (10 PCS.)	1	
3	949-497	ROLL PIN D4X16 (10 PCS.)	1	
4	988-812	SPECIAL NUT M18 (TM)	1	
5	988-813	SPRING PLATE	1	
7A	988-274	MACHINE SCREW (W/WASHERS) M5X8	1	
8	988-806	SPECIAL BOLT M12	1	
9	949-437	BOLT WASHER M12 (10 PCS.)	1	
10	988-804	WISE (A)	1	
11A	949-434	BOLT WASHER M10 (10 PCS.)	1	
12	988-805	SCREW CONNECTOR	1	
13A	949-434	BOLT WASHER M10 (10 PCS.)	1	
14	949-697	BOLT M12X45 (10 PCS.)	2	
15	949-463	SPRING WASHER M12 (10 PCS.)	2	
16A	990-541	MACHINE SCREW (W/WASHERS) M5X16	2	
18		CAUTION PLATE	1	
19	988-808	PLATE	1	
20	988-810	KNOB	1	
21	949-747	ROLL PIN D6X25 (10 PCS.)	1	
22	988-809	FEED SCREW	1	
23	949-497	ROLL PIN D4X16 (10 PCS.)	1	
24	988-807	SCREW HOLDER	1	
25	964-833	L - BOLT 18MM	1	
26	949-464	SPRING WASHER M16 (10 PCS.)	1	
27	955-818	BOLT WASHER M16	1	
28A	304-043	MACHINE SCREW (W/WASHERS) M4X10 (BLACK)	1	
30	988-116	INDICATOR	1	
31	964-833	L - BOLT 18MM	1	
32	955-817	WASHER M16	1	
33	988-801	WISE (B)	1	
34	949-510	RIVET D2.5X4.8 (10 PCS.)	2	
35	988-814	ANGLE SCALE	1	
36	988-800	WISE FRAME (A) ASS'Y	1	INCLUD.34,35
37	949-780	HEX. SOCKET HD. BOLT M8X25 (10 PCS.)	1	
38	949-457	SPRING WASHER M8 (10 PCS.)	1	
39	949-841	HEX. SOCKET HD. BOLT M8X80 (10 PCS.)	3	
40	949-457	SPRING WASHER M8 (10 PCS.)	3	
41	988-823	SLIDE BASE	1	
42	949-581	NUT M12 (10 PCS.)	1	
43	978-847	CORD ARMOR D10.0	1	
44	978-849	CORD ARMOR D8.5	1	
45	949-455	SPRING WASHER M8 (10 PCS.)	4	
46	949-254	MACHINE SCREW M6X10 (10 PCS.)	4	
47	978-854	STOP ARM	1	
48	949-572	LOCK NUT M10 (10 PCS.)	2	
49	978-853	STOP PLATE	1	
50	949-458	SPRING WASHER M10 (10 PCS.)	2	
51	949-848	HEX. SOCKET HD. BOLT M10X30 (10 PCS.)	2	
52	949-572	LOCK NUT M10 (10 PCS.)	2	
53	978-864	KNOB BOLT M10	1	
54	978-879	NUT M10	1	

*: ALTERNATIVE PARTS

10-95

PARTS

CB 18FA

ITEM NO.	CODE NO.	DESCRIPTION	NO. USED	REMARKS
55	976-655	ARM PIN	1	
56	955-479	RETAINING RING (E - TYPE) FOR D6 SHAFT	2	
57	949-236	MACHINE SCREW M5X10 (10 PCS.)	2	
58	949-454	SPRING WASHER M5 (10 PCS.)	2	
59	949-431	BOLT WASHER M5 (10 PCS.)	2	
60	976-666	SET GAUGE	1	
61	949-556	NUT M6 (10 PCS.)	4	
63A	976-607	MACHINE SCREW (W/WASHERS) M6X16	3	
64	976-652	SWITCH PLATE	1	
65	976-651	RUBBER PACKING	1	
66	976-650	SWITCH BOX	1	
* 67	988-853	SWITCH NAME PLATE	1	
* 67		SWITCH NAME PLATE	1	FOR SUI,FRA,GBR,BEL
* 68	934-246	SWITCH 100V - 240V (1P SOLDER TYPE)	1	
* 68	306-287	SWITCH (A) (TOGGLE)	1	FOR FRG
69	976-662	WATERPROOF CAP	1	
70	976-595	HINGE (B)	1	
71	949-848	HEX. SOCKET HD. BOLT M10X35 (10 PCS.)	4	
72	949-458	SPRING WASHER M10 (10 PCS.)	4	
73	976-642	BEARING NUT	1	
74	976-643	BEARING WASHER	1	
75	949-556	NUT M6 (10 PCS.)	1	
76	951-674	HEX. SOCKET SET SCREW M6X30	1	
77	951-628	PLATE (B)	1	
78	972-983	TOOTHED LOCK WASHER	2	
79	968-771	HEX. SOCKET FLAT HD. SCREW M6X16	2	
80	948-193	NYLON CLIP	3	
81	949-216	MACHINE SCREW M4X10 (10 PCS.)	3	
82	951-617	SHAFT	1	
83	951-616	PLATE (A)	1	
84	976-644	SCREW (I)	1	
85	949-561	NUT M12 (10 PCS.)	1	
86	944-744	HEX. SOCKET SET SCREW M8X10	1	
87	976-680	BASE ASS'Y	1	INCLUD.110 - 113
88	976-640	SPRING (A)	1	
89	976-641	SPRING (B)	1	
90	976-646	SHAFT	1	
91	949-433	BOLT WASHER M8 (10 PCS.)	2	
92	976-645	RUBBER WHEEL	2	
93	949-433	BOLT WASHER M8 (10 PCS.)	2	
94	949-537	SPLIT PIN D3X15 (10 PCS.)	2	
95	988-039	OIL CUP	2	
96	976-594	HINGE (A)	1	
97	976-639	HINGE SHAFT	1	
98	949-433	BOLT WASHER M8 (10 PCS.)	1	
99	949-457	SPRING WASHER M8 (10 PCS.)	1	
100	949-568	LOCK NUT M8 (10 PCS.)	1	
101	988-621	CHAIN HOOK	1	
102	976-663	CHAIN	1	
103	949-432	BOLT WASHER M6 (10 PCS.)	1	
104	949-454	SPRING WASHER M5 (10 PCS.)	1	

*: ALTERNATIVE PARTS

PARTS

CB 18FA

ITEM NO.	CODE NO.	DESCRIPTION	NO. USED	REMARKS
105	949-821	HEX. SOCKET HD. BOLT M5X16 (10 PCS.)	1	
106	934-081	EARTH PLATE	1	TILL 5.1994
107	949-449	BOLT WASHER (BRASS) M5 (10 PCS.)	1	
108	949-299	MACHINE SCREW (BRASS) M5X10 (10 PCS.)	1	
109	976-661	CORD	1	
110	988-862	BASE RUBBER (C)	1	
111	988-860	BASE RUBBER (A)	2	
112	988-861	BASE RUBBER (B)	1	
113	949-334	FLAT HD. SCREW M5X16 (10 PCS.)	8	
114		NAME PLATE	1	
115		CAUTION PLATE	1	
116	949-254	MACHINE SCREW M6X10 (10 PCS.)	4	
117	949-455	SPRING WASHER M6 (10 PCS.)	4	
118	949-432	BOLT WASHER M6 (10 PCS.)	4	
119	976-621	FRONT COVER	1	
120	949-760	HEX. SOCKET HD. BOLT M6X25 (10 PCS.)	4	
121	949-457	SPRING WASHER M6 (10 PCS.)	4	
122	976-598	SPINDLE (B)	1	
123	976-599	WASHER	1	
124	976-601	SPINDLE HOLDER	1	
125	976-607	MACHINE SCREW (W/WASHERS) M6X16	2	
126	976-606	INDICATOR	1	
127	976-604	TENSION SPRING	1	
128	976-605	SLEEVE (A)	1	
129A	949-874	ROLL PIN D6X36 (10 PCS.)	1	
130	951-858	CLAMP BOLT M10	1	
131A	302-998	WASHER (I)	1	
132	949-556	NUT M6 (10 PCS.)	1	
133	949-455	SPRING WASHER M6 (10 PCS.)	1	
134	976-630	STABILIZER HEAD (A)	1	
135	976-635	BEARING PIN (B)	1	
136	949-660	HEX. SOCKET HD. BOLT M6X20 (10 PCS.)	2	
137	949-753	ROLL PIN D5X20 (10 PCS.)	2	
138	976-629	SLIDE PLATE	1	
139	976-631	STABILIZER BLOCK	1	
140	949-660	HEX. SOCKET HD. BOLT M6X20 (10 PCS.)	2	
141	949-455	SPRING WASHER M6 (10 PCS.)	2	
142	949-556	NUT M6 (10 PCS.)	1	
143	949-455	SPRING WASHER M6 (10 PCS.)	1	
144	976-671	STABILIZER (A)	2	
145	949-432	BOLT WASHER M6 (10 PCS.)	2	
146	949-755	HEX. SOCKET HD. BOLT M6X16 (10 PCS.)	2	
147	934-081	EARTH PLATE	1	TILL 5.1994
148		VINYL TUBE (I.D.8X1.0X30)	1	
149	934-028	CORD CLIP	1	
150	949-218	MACHINE SCREW M4X10 (10 PCS.)	2	
* 151	988-855	CORD ARMOR D8.8	1	
152	949-218	MACHINE SCREW M4X10 (10 PCS.)	1	
* 153	988-637	CORD	1	
* 153	952-806Z	CORD	1	FOR FIN
* 153	500-228Z	CORD	1	FOR GBR

*: ALTERNATIVE PARTS

10 - 95

PARTS

CB 18FA

ITEM NO.	CODE NO.	DESCRIPTION	NO. USED	REMARKS
154	973-554	WASHER M6	1	
155	606-ZZM	BALL BEARING 606ZZMC3PS2S	2	
156	976-634	BEARING PIN (A)	1	
157	949-432	BOLT WASHER M6 (10 PCS.)	1	
158	949-455	SPRING WASHER M6 (10 PCS.)	1	
159	949-556	NUT M6 (10 PCS.)	1	
160	973-554	WASHER M6	1	
161	606-ZZM	BALL BEARING 606ZZMC3PS2S	1	
162	973-554	WASHER M6	1	
163	606-ZZM	BALL BEARING 606ZZMC3PS2S	2	
164	976-633	BEARING PIN (B)	1	
165	949-218	MACHINE SCREW M4X10 (10 PCS.)	2	
166	934-028	CORD CLIP	1	
167	976-648	CORD ARMOR D8.5	2	
168	949-218	MACHINE SCREW M4X10 (10 PCS.)	2	
169	934-028	CORD CLIP	1	
170	976-684	FRAME	1	
171	994-035	SIDE HANDLE	1	
* 172A	988-863	TENSION KNOB	1	
* 172A	988-838	TENSION KNOB	1	FOR HOL
* 172	305-886	TENSION KNOB	1	FOR FIN
* 172	306-289	TENSION KNOB	1	FOR FRG
* 173	988-865	SET LABEL (B)	1	
* 173	988-854	SET LABEL (A)	1	FOR HOL
* 173	305-890	SET LABEL (C)	1	FOR FIN
* 173	306-288	SET LABEL (D)	1	FOR FRG
174	976-600	DISTANCE SLEEVE	1	
175A	976-608	SAW WHEEL (B)	1	
176	976-585	BAND SAW BLADE NO. 6 14TPI (HSS) (3PCS.)	1	
177	600-4VV	BALL BEARING 6004VVCMP2S	2	
178A	306-985	WASHER (H)	1	
180A	976-607	MACHINE SCREW (W/WASHERS) M6X16	1	
181	976-609	BEARING WASHER	1	
182	976-610	BEARING NUT	1	
183	988-852	SAW COVER (B)	1	
184	976-627	RUBBER BUSHING (A)	7	
185	976-612	HOLDER	1	
186	976-597	WISE SPRING	1	
187	939-540	RETAINING RING FOR D10 SHAFT (10 PCS.)	1	
188A	307-232	MACHINE SCREW (W/WASHERS) M6X12 (BLACK)	2	
190	976-637	DUSTER PLATE	1	
191	976-635	BEARING PIN (B)	1	
192	976-632	STABILIZER HEAD (B)	1	
193	949-455	SPRING WASHER M6 (10 PCS.)	1	
194	949-556	NUT M6 (10 PCS.)	1	
195	949-455	SPRING WASHER M6 (10 PCS.)	1	
196	949-556	NUT M6 (10 PCS.)	1	
197	949-652	HEX. SOCKET HD. BOLT M6X25 (10 PCS.)	1	
198	949-455	SPRING WASHER M6 (10 PCS.)	1	
199A	949-692	HEX. SOCKET HD. BOLT M6X35 (10 PCS.)	1	
200	949-455	SPRING WASHER M6 (10 PCS.)	1	

*: ALTERNATIVE PARTS

PARTS

CB 18FA

8/9

ITEM NO.	CODE NO.	DESCRIPTION	NO. USED	REMARKS
209	973-554	WASHER M6	1	
210	606-ZZM	BALL BEARING 606ZZMC3PS2S	1	
211	976-671	STABILIZER (A)	2	
212	949-432	BOLT WASHER M6 (10 PCS.)	2	
213	949-755	HEX. SOCKET HD. BOLT M6X16 (10 PCS.)	2	
214	973-554	WASHER M6	1	
215	606-ZZM	BALL BEARING 606ZZMC3PS2S	2	
216	976-633	BEARING PIN (B)	1	
217		CAUTION PLATE (K)	1	
218	976-624	KNOB M8	1	
219	949-256	MACHINE SCREW M6X16 (10 PCS.)	2	
220	949-455	SPRING WASHER M6 (10 PCS.)	2	
221	976-656	SWITCH ARM (A)	1	
222	976-657	SWITCH ARM (B)	1	
223	949-432	BOLT WASHER M6 (10 PCS.)	2	
224	949-455	SPRING WASHER M6 (10 PCS.)	2	
225	949-253	MACHINE SCREW M6X8 (10 PCS.)	2	
226	959-140	CONNECTOR 50091 (10 PCS.)	2	FOR HOL
227	949-454	SPRING WASHER M5 (10 PCS.)	4	
228	988-851	MOTOR (SINGLE PHASE) 220V	1	FOR HOL
229	988-850	RUBBER BAND	1	FOR HOL
230	951-030	FAN GUIDE <i>Discont</i>	1	<i>Hoop-6, 2-10-90.</i>
231	949-254	MACHINE SCREW M6X10 (10 PCS.)	2	
232	949-455	SPRING WASHER M6 (10 PCS.)	2	
233		CAUTION PLATE (J)	1	
234	976-622	SPINDLE COVER	1	
235	949-652	HEX. SOCKET HD. BOLT M6X25 (10 PCS.)	3	
236	949-455	SPRING WASHER M6 (10 PCS.)	3	
237	976-611	SPINDLE (A)	1	
238	949-218	MACHINE SCREW M4X14 (10 PCS.)	1	
239	949-453	SPRING WASHER M4 (10 PCS.)	1	
240	949-429	BOLT WASHER M4 (10 PCS.)	1	
241	973-313	NYLON CLIP	1	
242	976-649	CORD ARMOR D8.5	1	
243		CAUTION PLATE (N) FOR HOL	1	
244	949-254	MACHINE SCREW M6X10 (10 PCS.)	2	
245	949-455	SPRING WASHER M6 (10 PCS.)	2	
246	988-858	THERMAL BOX	1	FOR HOL
247	988-859	THERMAL PROTECTOR	1	FOR HOL
248	986-862	MACHINE SCREW (W/WASHERS) M4X10	2	FOR HOL
249	988-857	FASTON	2	FOR HOL
250	988-856	INSULATING SLEEVE	2	FOR HOL
251		CAUTION PLATE (L) FOR HOL	1	
252	988-639	STOPPER ASSY	1	INCLUD.251 FOR HOL
253	949-454	SPRING WASHER M5 (10 PCS.)	2	
254	949-236	MACHINE SCREW M5X10 (10 PCS.)	2	
255	620-1VV	BALL BEARING 6201VVCMP2S	1	
256	976-617	GEAR SHAFT	1	
257	930-511	FEATHER KEY 4X4X10	1	
258	600-2DD	BALL BEARING 6002DDUCMP2S	1	
259	976-618	INNER COVER	1	
260	972-018	SPROCKET (C)	1	

CB 18FA

g/g

PARTS

ITEM NO.	CODE NO	DESCRIPTION	NO. USED	REMARKS
261	949-426	WASHER M8 (10 PCS.)	1	
262	949-457	SPRING WASHER M8 (10 PCS.)	1	
263	949-558	NUT M8 (10 PCS.)	1	
264	976-619	CHAIN (A)	1	
265	600-0VV	BALL BEARING 6000VVCMP2S	1	
266	976-616	SECOND PINION	1	
267	600-1VV	BALL BEARING 6001VVCMP2L	1	
268	949-454	SPRING WASHER M5 (10 PCS.)	3	
269	949-241	MACHINE SCREW M5X20 (10 PCS.)	3	
270	976-672	SPRING (B)	1	
271	976-620	CHAIN TENSIONER	1	
272	948-114	BOLT (C)	1	
273	976-613	SPROCKET	1	
274	600-4VV	BALL BEARING 6004VVCMP2S	1	
275	976-614	SLEEVE (C)	1	
276	976-626	SLEEVE (B)	1	
277	600-4VV	BALL BEARING 6004VVCMP2S	1	
278	976-609	BEARING WASHER	1	
279	976-610	BEARING NUT	1	
280	976-615	SAW WHEEL (A)	1	
281	949-455	SPRING WASHER M6 (10 PCS.)	3	
282	949-660	HEX. SOCKET HD. BOLT M6X20 (10 PCS.)	3	
283		Vinyl Tube (30g.5 x 107 x 20)	2	Hook-5, 3-10-9e.
284	949437	Bolt Washer M6 (10 pcs.)	2	(Ex. H110-4, 20-11-91)

STANDARD ACCESSORIES

ITEM NO.	CODE NO.	DESCRIPTION	NO. USED	REMARKS
701	988-618	L-TYPE WRENCH 24MM	1	

OPTIONAL ACCESSORIES

ITEM NO.	CODE NO.	DESCRIPTION	NO. USED	REMARKS
901	976-580	BAND SAW BLADE NO. 1 24TPI (10 PCS.)	1	
902	976-581	BAND SAW BLADE NO. 2 18TPI (10 PCS.)	1	
903	976-582	BAND SAW BLADE NO. 3 14TPI (10 PCS.)	1	
904	976-583	BAND SAW BLADE NO. 4 10TPI (10 PCS.)	1	
905	976-584	BAND SAW BLADE NO. 5 8TPI (10 PCS.)	1	
906	976-586	BAND SAW BLADE NO. 7 10TPI (HSS) (3PCS.)	1	
907	988-620	BAND SAW BLADE NO. 8 (GRIT TYPE)	1	
908	976-681	BAND SAW BLADE NO. 9 10TPI (HSS) (3PCS.)	1	
909	976-685	BAND SAW BLADE NO. 10 8TPI (HSS) (3PCS.)	1	
910	988-635	WISE PLATE (B)	1	

STANDARD ACCESSORIES

CB 18FA

ITEM NO.	CODE NO.	DESCRIPTION	NO. USED	REMARKS
701	988-818	L - TYPE WRENCH 24MM	1	

OPTIONAL ACCESSORIES

ITEM NO.	CODE NO.	DESCRIPTION	NO. USED	REMARKS
901	976-580	BAND SAW BLADE NO. 1 24TPI (10 PCS.)	1	
902	976-581	BAND SAW BLADE NO. 2 18TPI (10 PCS.)	1	
903	976-582	BAND SAW BLADE NO. 3 14TPI (10 PCS.)	1	
904	976-583	BAND SAW BLADE NO. 4 10TPI (10 PCS.)	1	
905	976-584	BAND SAW BLADE NO. 5 8TPI (10 PCS.)	1	
906	976-586	BAND SAW BLADE NO. 7 10TPI (HSS) (3PCS.)	1	
907	988-620	BAND SAW BLADE NO. 8 (GRIT TYPE)	1	
908	976-681	BAND SAW BLADE NO. 9 18TPI (HSS) (3PCS.)	1	
909	976-685	BAND SAW BLADE NO. 10 8TPI (HSS) (3PCS.)	1	
910	988-635	WISE PLATE (B)	1	
911	309-877	BAND SAW BLADE NO.11 24TPI (HSS) (3PCS.)	1	

*: ALTERNATIVE PARTS