

HITACHI

LIST NO. 0609

ELECTRIC TOOL PARTS LIST

■ PLANER
Model F-30A

2001·6·1
(E8-1)

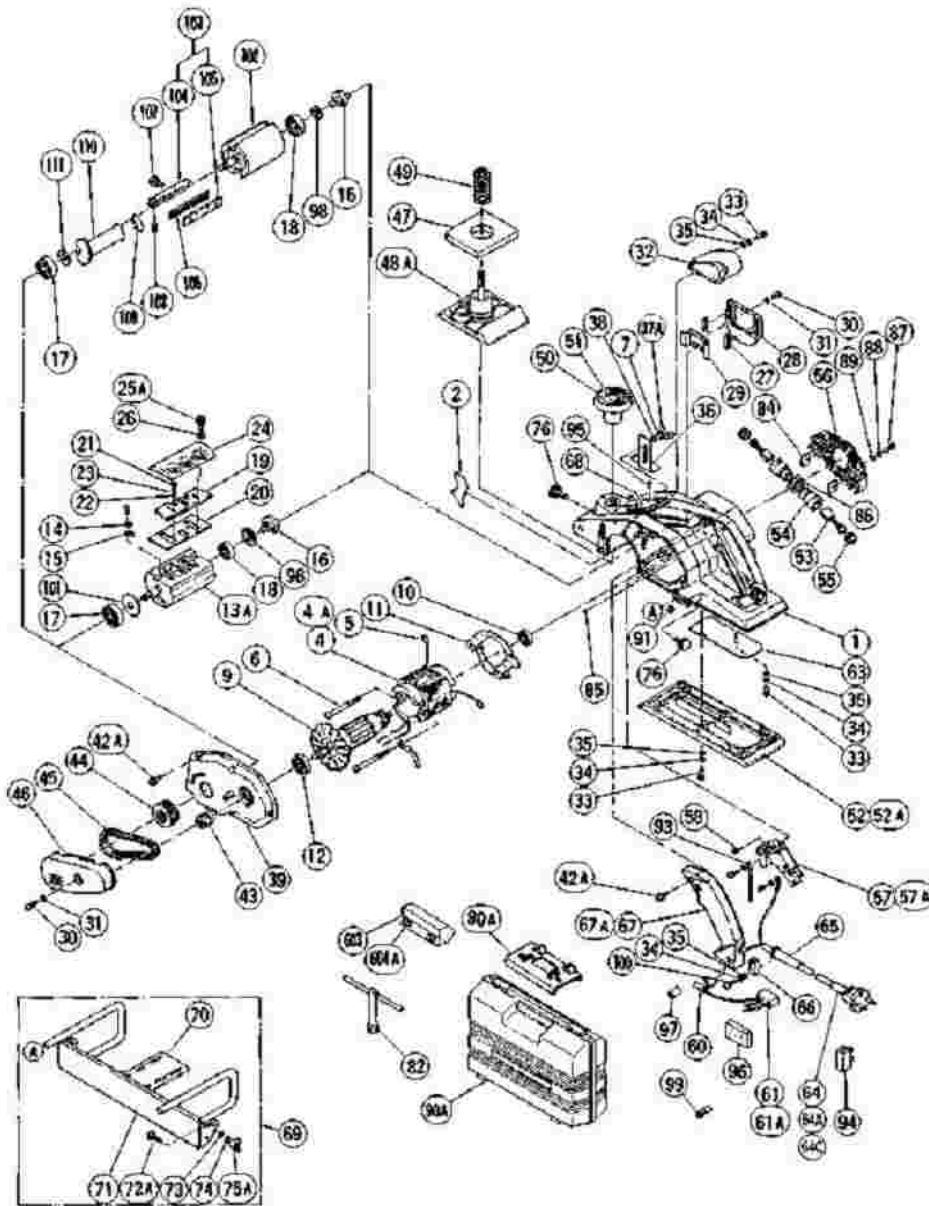

F30A

Pos. Nr.	Art. Nr.	Beschreibung	Stueck	Kommentar	Bescl
1	958-860	GEHAUSE F30A	1	INCLUD.6,29	HOUS ASS'Y
1	958-904Z		1	INCLUD.6,29 FOR FIN,SWE,NOR	HOUS ASS'Y
2	958-891	LUFTFUHRUNG (A) F30A	1		FAN C
4	958-862C		1	INCLUD.5	STATC 110V-
4	958-862D		1	INCLUD.5	STATC 120V-
4	958-862E	Stator 220-230V F30A	1	INCLUD.5	STATC 220V-
4	958-862F		1	INCLUD.5	STATC 240V
4	958-862G	STATOR 220V-230V F30A NEUE ART NR 958862	1	INCLUD.5 FOR DEN,FIN,SUI,ESP	STATC 220V-
4	958-862Z	STATOR 230V F30A ALTE ART NR 958862G	1	INCLUD.5 FOR NZL,FRG	STATC 230V
4	958-905G		1	INCLUD.5 FOR SAF	STATC 220V-
4	958-905F		1	INCLUD.5 FOR GBR,AUS	STATC 240V
4	958-905C		1	INCLUD.5 FOR GBR	STATC 110V
4	958-862L		1	INCLUD.5 FOR USA,CAN	STATC 110V-
4A	958-905E		1	INCLUD.5 FOR EUROPE	STATC 220V-
5	930-703	KOHLLENHALTERKLEMME DH28Y u a H30PV/VB16	2		BRUSI TERM
6	960-251	SCHNEIDSCHRAUBE D5X65 (DIV TYPEN)	2		HEX. I TAPPI SCREW
7	949-454	FEDERSCHEIBE M5 (10ST)	1		SPRIN WASH (10 PC
9	958-864U		1	INCLUD.10,12	ARMA ASS'Y 115V
9	958-864D		1		ARMA 120V-
9	958-864E	ANKER 220V-240V F30A	1		ARMA 220V-
9	958-		1		ARMA

	864F				240V
10	608-VVM	KUGELLAGER 608 VVM	1		BALL BEAR: 608VV
11	958-865	LUFTFUHRUNG (B) F30A	1		FAN C
12	620-0VV	KUGELLAGER 6200 VV	1		BALL BEAR: 6200V
13A	991-256	MESSERBLOCK KOMPLETT F30A	1	INCLUD.14-18,98,101	CUTTI BLOC
13A	958-903Z		1	INCLUD.14-18,98,101 FOR DEN,ESP	CUTTI BLOC
14	958-699	HALTEFEDER F30A/P50	4		HOLD SPRIN
15	958-700	SCHUTZVORRICHTUNGSPLATTE F30A/P50	4		GUAR (A)
16	958-824Z	WELLE (B) F30A/P20SA/SA2/SE	1		SHAFT
17	620-1VV	KUGELLAGER 6201 VV	1		BALL BEAR: 6201V
18	629-DDM	KUGELLAGER 629 DDM	1		BALL BEAR: 629DD
19	958-867	HSS-HOBELMESSER (PAAR) F30A Neue Art -Nr	2		PLANI BLAD (1 PAI
19	958-893Z	HSS-HOBELWENDEMESSER F30A	2		PLANI BLAD (DOU EDGE PAIR)
20	958-868	SPANNPLATTE F30A	2		BACK
21	949-215	+KOPFSCHRAUBE M4X 8 (10ST)	4		MACH SCREW (10 PC
22	949-423	UNTERLEGSCHIEBE M4 (10ST)	4		WASH (10 PC
23	949-453	FEDERSCHIEBE M4 (10ST)	4		SPRIN WASH (10 PC
24	958-869	MESSERHALTER F30A	2		BLAD HOLD PAIR)
25A	958-	BOLZEN M7X15 F30A/P20SA	6		BOLT (W/W

	917				M7X1:
26	940-391	UNTERLEGSCHLEIBE F30A/P50	6	TILL 9.1987	WASH
27	958-839Z	MAGNET F30A/P20SA/SA2/SE	2		MAGN
28	958-902	MESSERABDECKUNG F30A	1		BLAD
29	958-899	DECKEL F30A	1	INCLUD.28	COVE
30	949-218	+KOPFSCHRAUBE M4X14 (10ST)	3		MACH SCREW (10 PC
31	949-453	FEDERSCHLEIBE M4 (10ST)	3		SPRIN WASH (10 PC
32	958-870	SPANAUWURF F30A	1		CHIP (
33	954-004	SCHNEIDSCHRAUBE D4X16	9		TAPPI SCREW
34	949-453	FEDERSCHLEIBE M4 (10ST)	11		SPRIN WASH (10 PC
35	949-423	UNTERLEGSCHLEIBE M4 (10ST)	11		WASH (10 PC
36	958-840Z	TIEFENANSCHLAG F30A/P20SA	1		DEPTH
37A	949-395	FLUGELSCHRAUBE M5X6 (10ST)	1		WING M5X6
38	949-424	UNTERLEGSCHLEIBE M5 (10ST)	1		WASH (10 PC
39	958-871	ENDKONSOLE F30A	1		END B
42A	306-999	SCHNEIDSCHRAUBE D4X25 M FLANSCH	7		TAPPI SCREW (W/FL D4X25
43	958-872	SCHEIBE (A) F30A	1		PULLI
44	958-873	SCHEIBE (B) F30A	1		PULLI
45	958-874	RIEMEN F30A/SB10T/SB10	1		BELT
46	958-875	RIEMENSCHUTZ F30A	1		BELT
47	958-876	GUMMIDICHTUNG F30A	1		RUBB PACK
	958-				

48A	918	VORDERE GRUNDPLATTE F30A	1		FRONT
49	958-709	FEDER F30A/P20SA/SA2/SE/SD	1		SPRING
50	942-328	STELLKNOPF F30A/P20SA/SA2/SD/SE	1		KNOB
51	958-832Z	SKALA F30A/P20SA	1		SCALE
51	958-910		1	FOR USA,CAN	SCALE
52	958-878		1		REAR
52A	958-908Z	HINTERE GRUNDPLATTE F30A	1	FOR ITA,HOL,FIN	REAR
53	999-043	KOHLLENBURSTEN (PAAR)	2		CARB BRUSH (PAIR)
54	958-900	KOHLLENHALTER F30A/C6U-C9U u a H30PV/DH3	2		BRUSH HOLD
55	945-161	KOHLLENKAPPE C6U/C7U u a H30PV/DH30PC	2		BRUSH
56	958-879	HINTERABDECKUNG F30A	1		TAIL C
57	986-201	Schalter (A) fur G18Y/F30A	1		SWITCH SCREW W/LOCK
57	956-632	SCHALTER SB110 (F30A BIS 4 1996) (F30A A	1	FOR NZL,AUS,SAF (TILL 4.1996 FOR FRG,	SWITCH SCREW W/LOCK
			0	DEN,ESP,SUI)	
57	953-249P	SCHALTER F30A (AB 5 1996)	1	FOR FIN (SINCE 5.1996 FOR FRG,DEN,SUI,	SWITCH SCREW W/O L
			0	ESP)	
57	931-573	SCHALTER F30A/G13SC/P50 u a	1	TILL 4.1996 FOR AUT,NOR	SWITCH PILLA W/LOCK
57	953-178	SCHALTER CS35B/P50/SB10V u a	1	FOR FRA	SWITCH PILLA W/SAFE LOCK
57A	960-280Z	SCHALTER CR17Y/F30A	1	FOR GBR,ITA,HOL,SWE,USA,CAN (SINCE	SWITCH PILLA W/O L
			0	5.1996 FOR AUT,NOR)	
58	954-017	SCHNEIDSCHRAUBE D4X12	1		TAPPI SCREW
	959-	VERBINDER 50091 (10ST) DIV			CONN

60	140	TYPEN	1		50091
61	960-283Z		1	FOR SUI	NOISE SUPPF
61A	994-273	KONDENSATOR DIV TYPEN	1		NOISE SUPPF
63	958-882	FIBERPLATTE F30A	1		FIBER
64	500-206Z		1	(CORD ARMOR D10.2) FOR ASIA (100V-127V)	CORD
64	500-213Z		1	(CORD ARMOR D8.2) FOR ASIA (220V-240V)	CORD
64	500-232Z		1	(CORD ARMOR D8.2) FOR GBR (110V)	CORD
64	500-234Z		1	(CORD ARMOR D8.2) FOR EUROPE,IND	CORD
64	500-240Z		1	(CORD ARMOR D8.2) FOR USA,CAN	CORD
64	500-408Z		1	(CORD ARMOR D8.2) FOR AUS	CORD
64A	500-424Z		1	(CORD ARMOR D8.2) FOR SIN	CORD
64A	500-435Z		1	(CORD ARMOR D8.2) FOR GBR (240V)	CORD
64C	500-235Z	ANSCHLUSSKABEL MIT STECKER BITTE 714500	1	(CORD ARMOR D8.2) FOR SAF	CORD
65	930-487	KABELKNICKSCHUTZ D8 2	1		CORD D8.2
65	930-026	KABELKNICKSCHUTZ D10 2	1		CORD D10.2
66	937-631	KABELKLEMME DIV TYPEN	1		CORD
67	958-883	GRIFFDECKEL F30A (BIS 4 1996) (AB 5 1996	1	(TILL 4.1996 FOR FRG,DEN,SUI,ESP,AUT,	HAND COVE
			0	NOR)	
67A	958-907Z	HANDGRIFFDECKEL F30A (AB 5 1996)	1	W/O LOCK SWITCH FOR GBR,ITA,HOL,FRA,SWE,	HAND COVE
			0	USA,CAN (SINCE 5.1996 FOR FRG,DEN,SUI,	
			0	ESP,AUT,NOR)	
68			1		NAME
69	958-886	WINKELANSCHLAG F30A	1	INCLUD.70-75A	BEVEL ASS'Y
70	958-887	PARALLELANSCHLAG F30A	1		GUIDE
71	958-888	SCHRAGANSCHLAG F30A	1		BEVEL

72A	963-492	SCHLOSSSCHRAUBE M5X22 F30A/P50	2		BOLT (SQUA M5X22
73	949-424	UNTERLEGSCHEIBE M5 (10ST)	2		WASH (10 PC
74	949-454	FEDERSCHEIBE M5 (10ST)	2		SPRIN WASH (10 PC
75A	963-493	FLUGELMUTTER M5 F30A/P50	2		WING
76	940-650	ANSCHLAGSCHRAUBE F20A/F30A	2		STOPE SCREW
80A	958-916	EINSTELLEHRE F30A	1		SET G
82	940-543	STECKSCHLUSSEL 10MM C8FS/P20SA	1		BOX V 10MM
84	958-898	GUMMISTUCK F30A	2		RUBB
85	946-362	LAGERVERRIEGELUNG (DIV TYPEN)	1		BEAR. LOCK
86	958-901	FIBERSCHEIBE (A) F30A	2		FIBER WASH
87	956-384	SCHNEIDSCHRAUBE D4X20	4		TAPPI SCREW
88	949-453	FEDERSCHEIBE M4 (10ST)	4		SPRIN WASH (10 PC
89	949-423	UNTERLEGSCHEIBE M4 (10ST)	4		WASH (10 PC
90A	314-837	TRANSPORTKOFFER P20SD/F30A/VB16Y	1		CASE
91	949-555	MUTTER M5 (10ST)	1		NUT M PCS.)
93	971-825	VERBINDERKABEL CS35B/H55SA/VRV16	1		INTER WIRE
94	938-307	SCHRAUBKLEMME 1-REIHIG DIV TYPEN	1		PILLA TERM
95	949-509	NIETE D2 5X3 2 (10ST)	4		RIVET (10 PC
96	963-243	POLSTER (SELBSTKLEBEND) DIV TYPEN	1		SUPPC
97	981-373	ADERENDHULSE (D) DIV TYPEN	2	FOR FRA,AUS	TUBE
98	958-915	SCHEIBE (A) F30A/P20SA2/SE	1		WASH
99	961-419Z	KLEMME CM6/CS35B/D13/u a	1	FOR NOISE SUPPRESSOR FOR HOL	TERM

99	938-108	KABELSCHUH M5 (O ISO) DIV TYPEN	1	FOR NOISE SUPPRESSOR	TERM
100	984-750	SCHNEIDSCHRAUBE D4X16 MIT FLANSCH	2		TAPPI SCREW (W/FL D4X16)
101	944-954	LAGERSCHEIBE F30A/H65SB/SD u a H70SA	1		BEAR. WASH
102	308-061		1	FOR ADJUST SCREW TYPE	CUTTI BLOC (A)
102	308-061		0	INCLUD.16-18,98,109-111	CUTTI BLOC (A)
103	308-060		2	(2 SET) FOR ADJUST SCREW TYPE	BLAD HOLD
103	308-060		0	INCLUD.107,108	BLAD HOLD
104	308-107		2	FOR ADJUST SCREW TYPE	BLAD HOLD PAIR)
105	308-108	BLATTHALTER(B) - 1 PAAR FUR F30A	2	FOR ADJUST SCREW TYPE	BLAD HOLD PAIR)
106			2		PLANI BLAD PAIR)
106			0	FOR ADJUST SCREW TYPE	
107	963-472Z	BOLZEN M5 P50	6	FOR ADJUST SCREW TYPE	BOLT
108	938-477	INBUSSTIFTSCHRAUBE M5X8	4	FOR ADJUST SCREW TYPE	HEX. S SET S0 M5X8
109	308-062		2	FOR ADJUST SCREW TYPE	INSER (A)
110	990-665		2	FOR ADJUST SCREW TYPE	INSER
111	308-063		1	FOR ADJUST SCREW TYPE	BEAR. WASH