

ELECTRIC TOOL PARTS LIST

■ HAMMER DRILL

1985-3-30

Model VRT-22A

VRT-22A(E4)

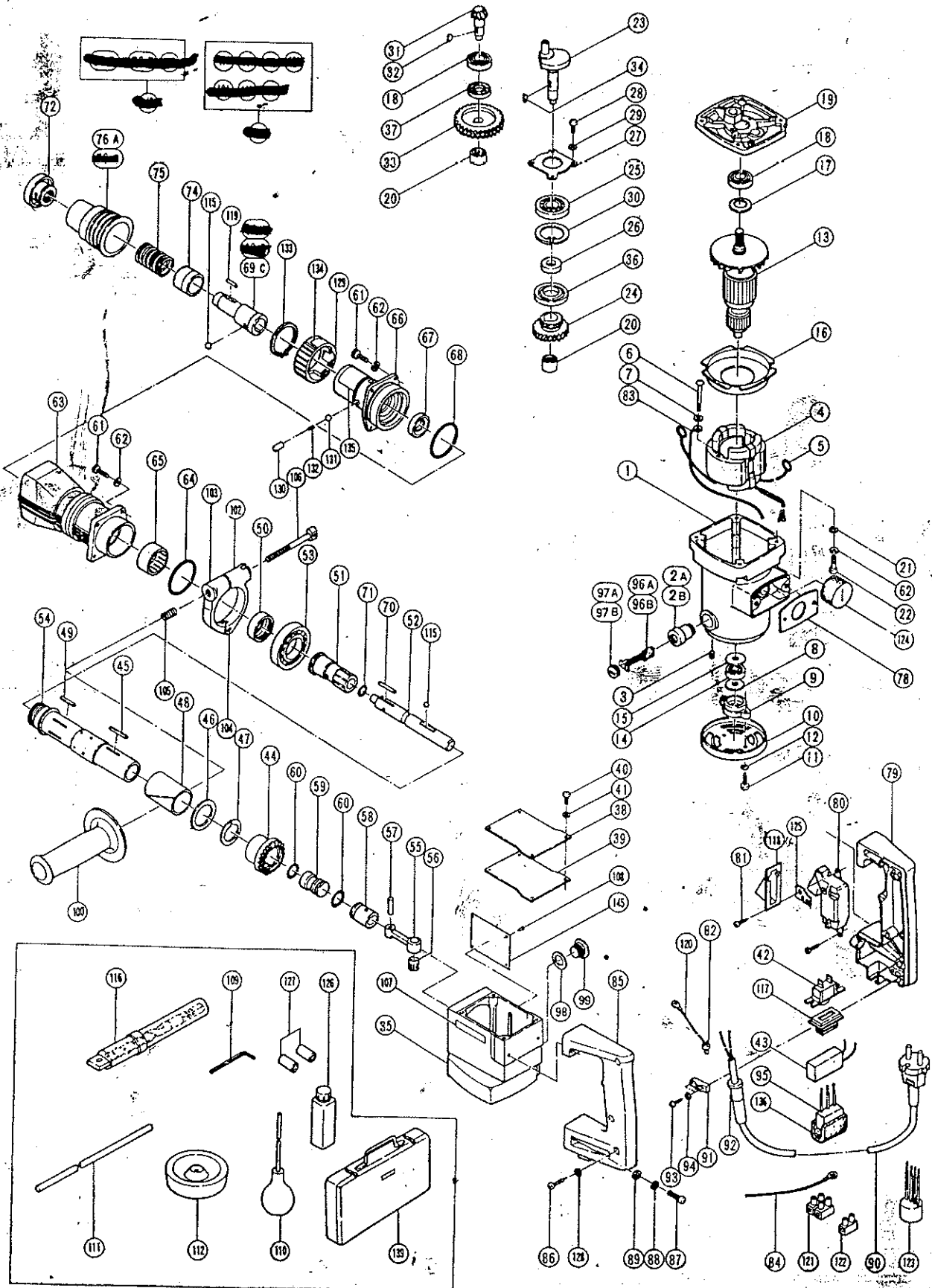

PARTS

VRT-22A(E4)

Item No.	Code No.	Part Name	Q'ty	Remarks
1	980671	Housing Ass'y	1	includ. 2B, 3
2A	931265	Brush Holder	2	till 4, 1984
2B	990721	Brush Holder	2	since 5, 1984
3	938477	Hexagon Socket Hd. Screw M5 x 8	2	
5	930630	Brush Terminal Ass'y	2	
6	949249Z	⊕ Hd. Machine Screw M5 x 45	2	(10 pcs.)
7	949454Z	Spring Lock Washer	2	for M5 (10 pcs.)
8	955108	Washer	1	
9	956382	Bearing Holder	1	
10	956383	Tail Cover	1	
11	956384	⊕ Tapping Screw M4 x 20	2	
12	949453Z	Spring Lock Washer	2	for M4 (10 pcs.)
14	939385	Ball Bearing (608VVC2)	1	
15	956387	Dust Seal (A)	1	
16	971735	Fan Guide	1	
17	971736	Washer (B)	1	
18	957564	Ball Bearing (6001VVCM)	2	
19	980651Z	Gear Cover	1	
20	956391	Needle Bearing (M551)	2	
21	949424Z	Washer	4	for M5 (10 pcs.)
22	944487	Hexagon Socket Hd. Bolt M5 x 40	4	
23	971738	Crank Shaft	1	
24	971739	First Gear	1	
25	939459	Ball Bearing (6202VVC2)	1	
26	971740	Collar	1	
27	971741	Bearing Cover	1	
28	949217Z	⊕ Hd. Machine Screw M4 x 12	4	(10 pcs.)
29	949453Z	Spring Lock Washer	4	for M4 (10 pcs.)
30	948409	C-Type Retaining Ring	1	for D35 hole
31	971742	Third Pinion	1	
32	940220	Woodruff Key 2.5 x 8	1	
33	971743	Second Gear	1	
34	932815	Woodruff Key 3 x 13	1	
35	980652Z	Crank Case	1	
36	971745	Oil Seal (A)	1	
37	971746	Oil Seal (B)	1	
38	980653Z	Cover Plate	1	
39	971748	Cover Seal	1	
40	949237Z	⊕ Hd. Machine Screw M5 x 12	4	(10 pcs.)
41	949454Z	Spring Lock Washer	4	for M5 (10 pcs.)
42	—	Slide Switch	1	See alternative parts
43	—	Diode Ass'y	1	See alternative parts
44	971749	Third Gear	1	
45	971750	Feather Key 3 x 3 x 20	2	
46	971751	Cylinder Washer	1	
47	948310	C-Type Retaining Ring	1	for D30 shaft
48	971752	C-Type Spring	1	
49	971753	Needle D4 x 25.8	6	
50	971754	Cylinder Cap	1	
51	971755	Shaft Sleeve	1	
52	980654Z	Slide Shaft	1	
53	971814	Ball Bearing (6006C2)	1	
54	971757	Cylinder	1	

PARTS

VRT-22A(E4)

Item No.	Code No.	Part Name	Q'ty	Remarks
55	956405	Connecting Rod Ass'y	1	includ. 56
56	956406	Needle Bearing	1	
57	971821	Piston Pin	1	
58	971758	Piston	1	
59	971759	Striker	1	
60	971760	O-Ring	2	
61	949757Z	Hexagon Socket Hd. Bolt M5 x 20	8	(10 pcs.)
62	949454Z	Spring Lock Washer	12	for M5 (10 pcs.)
63	980655Z	Cylinder Case	1	
64	971762	O-Ring (C)	1	
65	971763	Needle Bearing (F 3520)	1	
66	980656Z	Front Cover	1	
67	971765	Oil Seal (C)	1	
68	971766	O-Ring (B)	1	
70	971768	Needle D3 x 23.8	2	
71	872654	O-Ring	1	
72	971769	Front Cap Ass'y 971769	1	
74	971771	Retainer Ring	1	
75	980682	Retainer Spring	1	
78	956431	Handle Washer	1	
79	971775	Handle (A)	1	
81	954017	⊕ Tapping Screw M4 x 12	2	
85	971778	Handle (B)	1	
86	958705	⊕ Tapping Screw M4 x 25	3	
87	949260Z	⊕ Hd. Machine Screw M6 x 25	4	(10 pcs.)
88	949455Z	Spring Lock Washer	4	for M6 (10 pcs.)
89	949425Z	Washer	4	for M6 (10 pcs.)
91	937631	Cord Clip	1	
93	954004	⊕ Tapping Screw M4 x 16	2	
94	949423Z	Washer	2	for M4 (10 pcs.)
97A	931266	Brush Cap	2	till 4, 1984
97B	937847	Brush Cap	2	since 5, 1984
98	971779	Cap Seal	1	
99	971780	Oil Cap	1	
100	971781	Side Handle	1	
101	980657Z	Handle Holder Ass'y	1	includ. 102 ~ 104
102	980658Z	Handle Holder (A)	1	
103	980659Z	Handle Holder (B)	1	
104	949785Z	Roll Pin D6 x 16	1	(10 pcs.)
105	672612	Spring	1	
106	971785	Handle Bolt	1	
107	950565	HITACHI Label	1	
108	949510Z	Rivet D2.5 x 4.8	4	(10 pcs.)
109	944458	Hexagon Bar Wrench 4	1	for M5 bolt
110	944575	Syringe	1	
111	971786	Stopper Rod	1	
112	971787	Dust Cup	1	
115	930243	Steel Ball 939451 D7.14	4	(50 pcs.)
	930243	Steel Ball D7.14	4	from 12, 1980 to 12, 1981 (50 pcs.)
116	—	Drill Bit Ass'y D12 x 150	1	See OPTIONAL ACCESSORIES
117	971792	Slide Switch Cover	1	
118	971793	Switch Cover	1	
119	971812	Needle Roller	2	till. 11, 1980 and since 1, 1982

ALTERNATIVE PARTS

VRT-22A(E4)

Item No.	Code No.	Part Name	Q'ty	Remarks
4	971732E	Stator Ass'y 220V ~ 230V	1	includ. 5
	971732F	Stator Ass'y for U.K. 240V	1	includ. 5 w/choke coil
	971732G	Stator Ass'y 230V	1	includ. 5 w/choke coil
	971732J	Stator Ass'y for U.K. 110V	1	includ. 5
	971732K	Stator Ass'y for Switzerland 220V	1	includ. 5
	971732C	Stator Ass'y for U.S.A.	1	includ. 5
13	971734C	Armature Ass'y for U.S.A. 110V ~ 115V	1	
	971734E	Armature Ass'y 220V ~ 230V	1	
	971734G	Armature Ass'y 220V	1	for West Germany, Australia, France, Finland, Switzerland
	971734H	Armature Ass'y for U.K. 240V	1	
	971734J	Armature Ass'y for U.K. 110V	1	
42	971734	Slide Switch <i>953261</i>	1	
	980669Z	Slide Switch Ass'y for U.S.A.	1	
43	957556	Diode Ass'y	1	
	971822Z	Diode Ass'y for U.S.A.	1	
			1	for France, Switzerland
	971737	Retainer (C)		
69C	980670Z	Retainer (C)	1	since 1, 1982
76A	971773	Slide Grip Ass'y	1	till 11, 1980
	971773	Slide Grip Ass'y		
80	956433	Single Pole Switch (Screw Type)	1	w/o lock
	955277	Double Pole Switch (Screw Type)	1	w/o lock
	971824Z	Double Pole Switch (Screw Type)	1	w/o lock for Switzerland
82	939310Z	Connector	4	(10 pcs.)
83	971776	Internal Wire Ass'y	1	
84	971825Z	Internal Wire Ass'y for Finland, Australia	1	
	971826Z	Internal Wire Ass'y for Europe	1	
90	500232Z	Cord Ass'y for U.K.	1	w/o terminal, w/o plug
	500235Z	Cord Ass'y for Europe	1	w/o terminal
	—	Cord Ass'y for Switzerland	1	
	—	Cord Ass'y for U.S.A.	1	w/o terminal
92	930487	Cord Armor D8.2	1	
	930354	Cord Armor D10.2	1	
95	958847	Noise Suppressor	1	w/o terminal
	—	Noise Suppressor for Switzerland	1	w/o terminal
	971828Z	Noise Suppressor for Finland, Australia	1	w/o terminal
96A	999035	Carbon Brush	2	till 4, 1984 (2 pcs.)
96A	980666Z	Carbon Brush	2	auto stop type (2 pcs.)
96B	999021	Carbon Brush	2	since 5, 1984 (2 pcs.)
96B	999084	Carbon Brush	2	auto stop type since 5, 1984 (2 pcs.)
120	956455	Internal Wire Ass'y	1	
121	958308Z	Pillar Terminal (A)	1	

ALTERNATIVE PARTS

VRT-22A(E4)

Item No.	Code No.	Part Name	Q'ty	Remarks
122	938307Z	Pillar Terminal	1	
123	980685	Choke Coil	1	
135	980663Z	Label (B)	1	
	—	Label (C) for West Germany, Australia, France	1	
136	930153	Support (B)	1	
140	980683Z	Retainer Sleeve Ass'y	1	includ. 69B, 76B, 115 since 12, 1980
145	—	Name Plate	1	

OPTIONAL ACCESSORIES

Item No.	Code No.	Part Name	Q'ty	Remarks
	971970	Drill Bit Ass'y D5 x 109	1	
	971971	Drill Bit Ass'y D5 x 159	1	
	971972	Drill Bit Ass'y D6.5 x 109	1	
	971973	Drill Bit Ass'y D6.5 x 159	1	
	971974	Drill Bit Ass'y D8 x 109	1	
	971975	Drill Bit Ass'y D8 x 159	1	
	971979	Drill Bit Ass'y D12 x 159	1	
	971980	Drill Bit Ass'y D12 x 209	1	
	971986	Drill Bit Ass'y D16 x 209	1	
	971987	Drill Bit Ass'y D16 x 359	1	
	971991	Drill Bit Ass'y D22 x 209	1	
	971992	Drill Bit Ass'y D22 x 359	1	
	971995	Drill Bit Ass'y D12.7 x 159	1	
	971807	Anchor Setting Adapter W 1/4"	1	for electric hammer drill
	971808	Anchor Setting Adapter W 5/6"	1	for electric hammer drill
	971809	Anchor Setting Adapter W 3/8"	1	for electric hammer drill
	971810Z	A Taper Adapter Ass'y	1	
	971811Z	B Taper Adapter Ass'y	1	
	971799	Anchor Setting Adapter W 1/4"	1	for manual hammer
	971800	Anchor Setting Adapter W 5/16"	1	for manual hammer
	971801	Anchor Setting Adapter W 3/8"	1	for manual hammer
	971802	Anchor Setting Adapter W 1/2"	1	for manual hammer
	971803	Anchor Setting Adapter W 5/8"	1	for manual hammer
	984276	Chuck Adapter	1	
	950264	Chuck Ass'y 13VL	1	includ. chuck handle ass'y 10G
	930515	Chuck Handle Ass'y 10G	1	
	971813	Electric Hammer Oil	1	
	984269	Chuck Adapter (B)	1	for France, Switzerland, F.R. Germany, Sweden

