



LIST NO. 0440

ELECTRIC TOOL PARTS LIST

■ HAMMER DRILL
Model VRY-38

1988-8-20
VRY-38(E5)

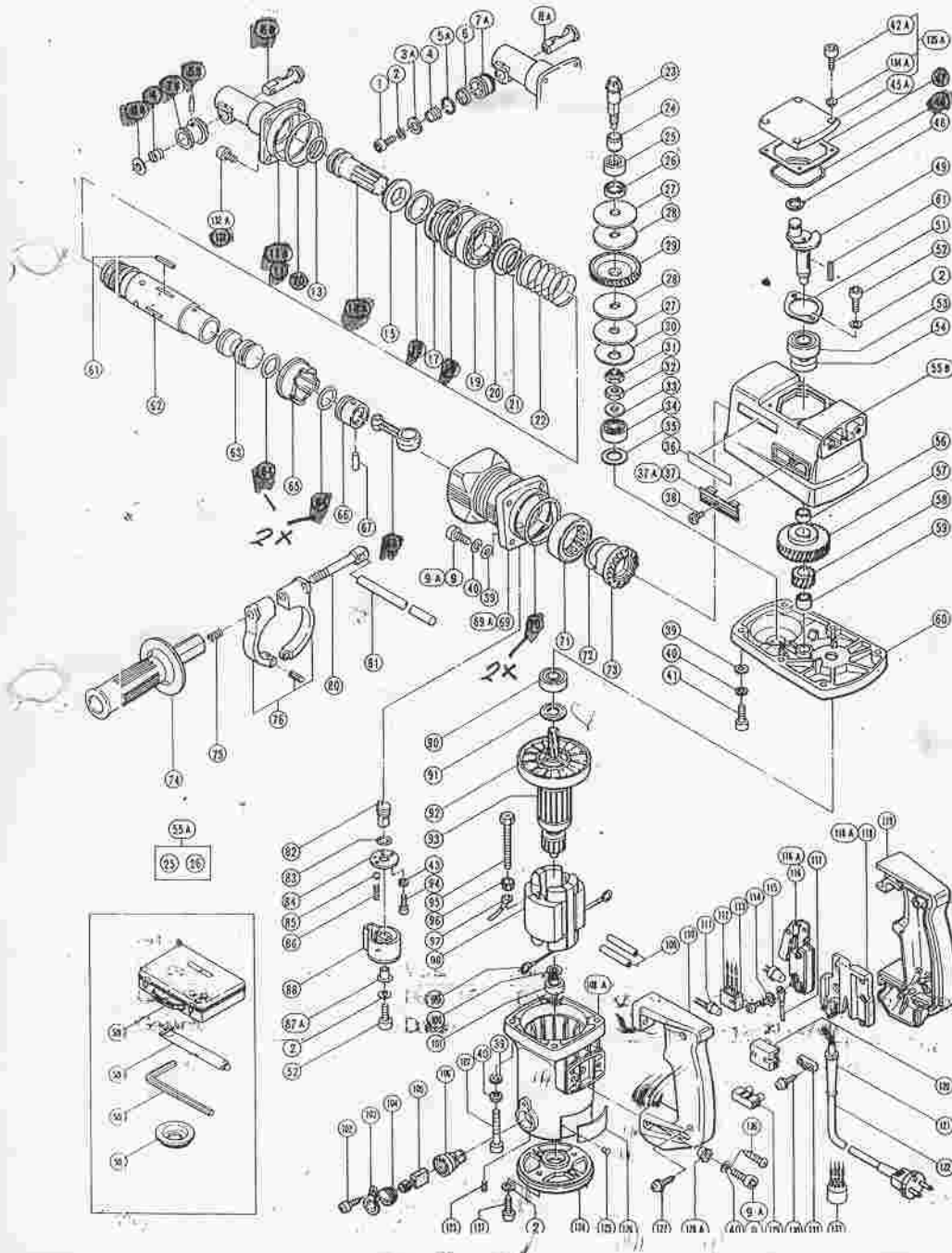

PARTS

VRY-38(E5)

Item No.	Code No.	Part Name	Qty	Remarks
1	949765	Hexagon Socket Hd. Bolt M5 x 12	1	till 12. 1981 (10 pcs.)
2	949454	Spring Lock Washer	5	for M5 (10 pcs.)
3A	949454	Washer (A)	1	till 12. 1981 (except Italy, Sweden)
3B	983242	Stopper Washer	1	since 1. 1982 (since 11. 1981 for Italy, Sweden)
4	981937	Stopper Spring	1	
5A	949454	Washer (B)	1	till 12. 1981 (except Italy, Sweden)
5B	943364	Needle Roller	1	since 1. 1982 (since Nov. 1981 for Italy, Sweden)
6	981888	Rubber Washer	1	till 12. 1981 (except Italy, Sweden)
7A	949454	Knob	1	till 12. 1981 (except Italy, Sweden)
7B	983241	Knob (A)	1	since 1. 1982 (since 11. 1981 for Italy, Sweden)
8A	949454	Stop Lever	1	till 12. 1981 (except Italy, Sweden)
8B	983240	Stop Lever	1	since 1. 1982 (since 11. 1981 for Italy, Sweden)
9	949454	Hexagon Socket Hd. Screw M6 x 25	5	till 11. 1984 (10 pcs.)
	949454	Hexagon Socket Hd. Bolt M6 x 25	4	since 12. 1984 for Handle (B) [Seal Lock Bolt] (10 pcs.)
9A	991700	Hexagon Socket Hd. Bolt M6 x 28	4	since 12. 1984 (Seal Lock Bolt)
11	981865	Front Cover	1	till 12. 1984
11A	949454	Front Cover	1	since 1. 1985
13	981857	O-Ring (C)	1	
14A	990144	Second Hammer	1	
15	981862	Damper Washer	1	
16	981861	Damper	1	
17	981860	Cylinder Cap	1	
18	981859	Urethane Ring	1	
19	9007DD	Ball Bearing 6007DDUAV2S	1	
20	981973	Cylinder Washer	1	
21	981858	Valve Band	1	
22	981957	Spring (A)	1	
23	981849	Third Pinion	1	
24	981850	Sleeve	1	
25	981852	Needle Bearing (A)	1	
26	981851	Oil Seal (B)	1	
27	956207	Slip Plate (B)	2	
28	981941	Clutch Plate	2	
29	981848	Second Gear	1	
30	944514	Belleville Spring	1	
31	981884	Special Nut (B)	1	
32	981883	Special Nut (A)	1	
33	944516	Bearing Washer (B)	1	
34	929VVM	Ball Bearing 629VVMC2EPS2L	1	
35	944525	Bearing Washer (C)	1	
36	957561	HITACHI Label	1	
37	980735	Wind Guide	2	till 11. 1987
37A	991713	Wind Guide (B)	2	since 12. 1987
38	949322	Flat Hd. Screw M4 x 10	2	till 11. 1987 (10 pcs.)
39	949432	Bolt Washer	8	for M6 (10 pcs.)
40	949455	Spring Lock Washer	14	for M6 (10 pcs.)
41	949660	Hexagon Socket Hd. Bolt M6 x 20	2	(10 pcs.)
42A	983162	Hexagon Socket Hd. Bolt M4 x 12	4	(10 pcs.)
45A	987709	Crank Cover	1	
45	980744	O-Ring (S-55)	1	
47	980749	Seal Packing	1	
48	989542	C-Type Retaining Ring	1	for D12 Shaft (10 pcs.)
49	981844	Crank Shaft	1	

PARTS

VRY-38(E5)

Item No.	Code No.	Part Name	Q'ty	Remarks
E1	981847	Bearing Cover	1	
E2	949665	Hexagon Socket Hd. Screw M5 x 14	4	(10 pcs.)
E3	6203VV	Ball Bearing 6203VVCMP2S	1	
E4	971745	Oil Seal (A)	1	
E4B	991768	Crank Case Ass'y	1	includ. 25, 26, 37A
E5	980706	Collar	1	
E7	981845	First Gear	1	
E8	981846	Second Pinion	1	
E9	939299	Needle Bearing (M661)	1	
E0	981952	Gear Cover	1	
E1	971750	Key 3 x 3 x 20	5	
E2	981969	Cylinder	1	
E3	981855	Striker	1	
E4	980710	O-Ring	2	
E5	981956	Clutch	1	
E5	981885	Piston	1	
E7	980708	Piston Pin	1	
E3	980707	Connecting Rod	1	
E9	982424	Cylinder Case	1	till 12. 1984
E4	980994	Cylinder Case	1	since 1. 1985
70	956996	O-Ring (S-60)	2	
71	981955	Needle Bearing (B) 993069	1	
72	981955	Thrust Washer	1	
73	981954	Third Gear	1	
74	981870	Side Handle	1	
75	672612	Spring	1	
75	981960	Handle Holder	1	
80	971785	Handle Bolt	1	
81	971786	Stopper Rod	1	
82	981964	Lever Shaft	1	
83	981967	O-Ring (A)	1	
84	981965	Shaft Cover	1	
85	959155	Steel Ball D3.969	1	(10 pcs.)
85	981965	Spring (B)	1	
87A	991711	Distance Piece (B)	1	
87	981963	Lever	1	
90	6202VV	Ball Bearing 6202VVCMP2S	1	
91	980700	Dust Washer (B)	1	
92	980740	Fan	1	
93	—	Armature Ass'y	1	See alternative parts
94	949613	Hexagon Socket Hd. Screw M4 x 12	2	(10 pcs.)
95	960251	Hexagon Hd. Tapping Screw D5 x 65	2	
96	956764	Special Washer	3	
97	—	Internal Wire	1	See alternative parts
98	—	Stator Ass'y	1	See alternative aprts
99	930703	Brush Terminal	2	
100	980698	Dust Washer (A)	1	
101	608VVM	Ball Bearing 608VVMC2EPS2L	1	
101	958715	Tapping Screw D4 x 10	2	
101	981959	Brush Cap Cover	2	
101	961781	Brush Cap	2	
101	9816122	Carbon Brush	2	auto stop type (2 pcs.)
101	981586	Brush Holder	2	

PARTS

VRY-38(E5)

Item No.	Code No.	Part Name	Q'ty	Remarks
107	949782	Hexagon Socket Hd. Screw M6 x 50	4	(10 pcs.)
108A	991767	Housing Ass'y (B) <i>Call to Mn 981950</i>	1	includ. 106, 123, 136, 137
109	—	Vinyl Tube	1	for 7D x 0.5T x 170
110	981867	Handle (B)	1	
111	959140	Connector (50091)	1	(10 pcs.)
112	—	Noise Suppressor	1	See alternative parts
113	—	Support (B)	1	
114	949423	Washer	1	for M4 (10 pcs.)
115	—	Connector (50092)	1-2	See alternative parts (10 pcs.)
116	—	Switch	1	See alternative parts
117	—	Internal Wire	1	See alternative parts
118	—	Support	1	See alternative parts
119	881866	Handle (A)	1	
120	—	Pillar Terminal	1	See alternative parts
121	—	Cord Armor	1	See alternative parts
122	—	Cord	1	See alternative parts
123	962782	Hexagon Socket Hd. Screw M5 x 6	2	
124	981951	Tail Cover	1	
125	949510	Rivet D2.5 x 4.8	2	(10 pcs.)
126	—	Name Plate	1	
127	956636	Tapping Screw D4 x 25	2	w/Washer
128A	990940	Distance Piece (C)	4	
129	938307Z	Pillar Terminal	1	
130	930446	Tapping Screw D4 x 16	2	w/Washer
131	—	Cord Clip	1	See alternative parts
132	981942	Special Bolt M6 x 25	4	till 12, 1984
132A	981942	Special Bolt M7 x 25	4	since 1, 1985 (Seal Lock Bolt)
133	—	Choke Coil	1	See alternative parts
134A	990146	Distance Piece (A)	4	
135A	993903	Crunk Cover Ass'y	1	includ. 42A, 45A, 134A
136	992802	Tapping Screw D6 x 25	2	
137	985480	Tapping Screw D5 x 20	2	

ALTERNATIVE PARTS

Item No.	Code No.	Part Name	Q'ty	Remarks
93	931971C	Armature Ass'y 110V ~ 115V	1	includ. 92
	931971D	Armature Ass'y 120V ~ 127V	1	includ. 92
	931971E	Armature Ass'y 220V ~ 230V	1	includ. 92
	931971F	Armature Ass'y 240V	1	includ. 92
	931971H	Armature Ass'y 240V	1	for U.K., includ. 92
	931971J	Armature Ass'y 110V	1	for U.K., includ. 92
	931971L	Armature Ass'y 220V	1	for Denmark, Finland, Sweden, Italy, F.R. Germany, France, Netherlands, includ. 92
97	971776	Internal Wire	1	
	971825Z	Internal Wire	1	for Finland, Austria
98	981970C	Stator Ass'y 110V ~ 115V	1	includ. 99
	981970D	Stator Ass'y 120V ~ 127V	1	includ. 99
	981970F	Stator Ass'y 240V	1	includ. 99
	981970G	Stator Ass'y 220V ~ 230V	1	for Denmark, Finland, Sweden, N.Z., Italy, F.R. Germany, France, Netherlands, includ. 99

ALTERNATIVE PARTS

VRV-38(E5)

Item No.	Code No.	Part Name	Q'ty	Remarks
	981970H	Stator Ass'y 240V	1	for Australia, Includ. 99
	981970J	Stator Ass'y 110V	1	for U.K., Includ. 99
	981970E	Stator Ass'y 220V ~ 230	1	Includ. 99
112	958847	Noise Suppressor	1	for U.K., Denmark, Sweden, N.Z., Italy, F.R., Germany, France, Netherlands
	971828	Noise Suppressor	1	for Finland, Austria
	958846Z	Noise Suppressor	1	for Switzerland
113	930153	Support (B)	1	for Switzerland, F.R., Germany, Finland, Austria
115	959141	Connector (50092)	1~2	for Netherlands, Denmark, Sweden, N.Z., U.K., Italy, France, F.R., Germany (110 pcs.)
116A	992891	Single Pole Switch (A) (Screw Type)	1	
	981533Z	Double Pole Switch (Pillar Type)	1	w/o lock for Oceania
117	981974Z	Internal Wire	1	for Netherlands, Denmark, Sweden, N.Z., U.K., Italy, France, F.R., Germany
118	981869	Support	1	
	981986Z	Support (A)	1	for Oceania
118A	990082	Support (E)	1	
120	958308Z	Pillar Terminal (A)	1	for Finland
121	940778	Cord Armor D10.7	1	
	958049Z	Cord Armor D8.2	1	
122	500239Z	Cord 110V ~ 240V	1	(Cord Armor D10.7)
	500235Z	Cord 110V ~ 240V	1	for F.R., Germany, Italy, France (Cord Armor D8.2)
	500394Z	Cord 220V ~ 240V	1	for Syria (Cord Armor D10.7)
	500224Z	Cord 230V ~ 240V	1	for Singapore (Cord Armor D10.7)
	500227Z	Cord 230V ~ 240V	2	for Oceania (Cord Armor D8.2)
	500406Z	Cord 110V ~ 240V	1	for U.K., S. Africa (Cord Armor D8.2)
	500390Z	Cord 220V	1	for Netherlands, Denmark, Finland, Sweden (Cord Armor D10.7)
	500391Z	Cord 220V	1	for Switzerland (Cord Armor D10.7)
	500249Z	Cord 115V	1	for U.S.A., Canada (Cord Armor D8.2)
131	960266	Cord Clip	1	
	981987Z	Cord Clip	1	for Switzerland
133	955908	Choke Coil	1	for N.Z.

STANDARD ACCESSORIES

Item No.	Code No.	Part Name	Q'ty	Remarks
500	985389	Case	1	
501	981840	Grease (A)	1	
502	94459	Hexagon Bar Wrench	1	
503	981875	Dust Cover	1	